

PROJECT _____ TYPE _____
SPECIFICATION _____

MAIN FEATURES

- 95 CRI Standard
- Versatile linear luminaire designed to easily adapt into your current track layout with a variety of optics
- Effective heat emission for thermal management
- Integrated driver meets IEEE 1789-2015 Low Risk flicker category across dimming range
- Custom optic platform to ensure excellent light control

CONSTRUCTION + FINISH

- Weight: 2 ft.: 1.5 lbs.; 4ft: 2.5 lbs.
- Rigid aluminum extruded body
- Standard finishes:
 - White: RAL 9003
 - Black: RAL 9005
 - Silver: RAL 7001

OPTICS + PERFORMANCE

- 4 custom beam spreads available
 - Lambertian
 - Narrow
 - Asymmetric
 - Bat-wing
- 2 ft.: 2300 or 1700 lumens at 19W or 1200 lumens at 13W
- 4 ft.: 4600 or 3600 lumens at 40W or 2600 lumens at 27W
- 6 ft.: 6800 or 5100 lumens at 60W or 3600 lumens at 40W
- Color Temperatures
 - 95 CRI: 2700K, 3000K, 3500K, 4000K, 5000K
- Fixture life: 50,000 hours

ELECTRICAL + CONTROLS

- 120V with phase-cut TRIAC and ELV dimming to 1%

MOUNTING

- J-type and H-type Track; 120V, 1-circuit/1-neutral

RATINGS + CERTIFICATIONS

- IP20 and IK08 rated
- UL Listed for dry location (E487826)
- RoHS-compliant
- BAA compliant
- Designed and assembled in U.S.A.

WARRANTY

- 5-year warranty

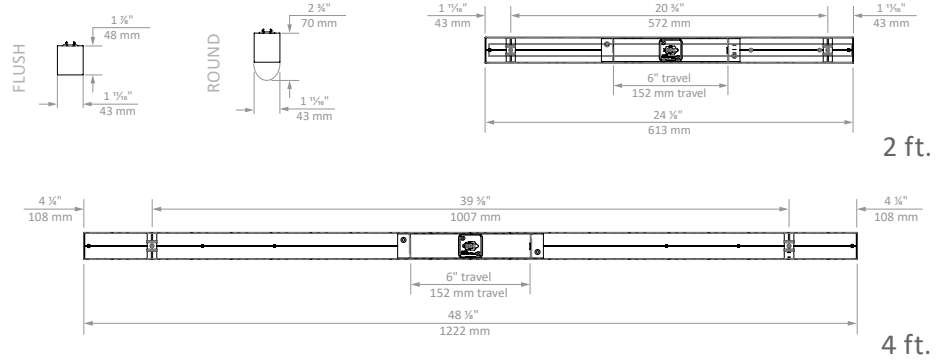
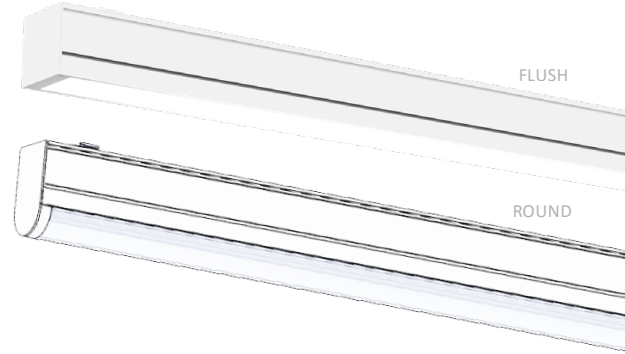

Ordering Information

Example: LCL/4F/1/DFL/930/3600/PW/J

Fixture	Length	Optic	Output	Track Type	Finish
LCL	2F - 2 feet	DFL - Diffuse Flush Lambertian DFN - Diffuse Flush Narrow DFA - Diffuse Flush Asymmetric DFB - Diffuse Flush Bat-wing DRL - Diffuse Round Lambertian	2300 (19W) 1700 (19W) 1200 (13W)	J H	PW - Perfect White BK - Black SV* - Silver
	4F - 4 feet		4600 (40W) 3600 (40W) 2600 (27W)		
	6F - 6 feet		6800 (60W) 5100 (60W) 3600 (40W)		



*Consult factory for lead time and availability

OPTIC DISTRIBUTIONS

LAMBERTIAN

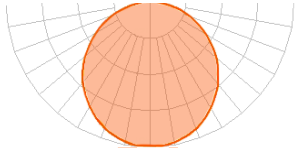

NARROW

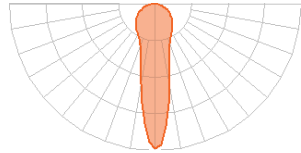

ASYMMETRIC

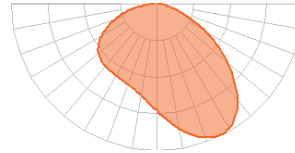

BAT-WING

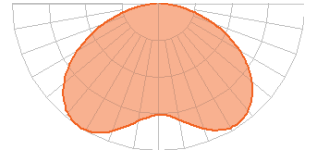

TM30 COLOR REPORTS

- 3000K with 95 CRI
- $R_A = 95$; $R_g = 62$
- $R_f = 92$; $R_g = 101$

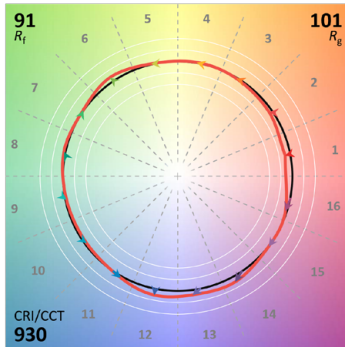

WARNING: Not for use in fully enclosed luminaires. Risk of electric shock. Use in an indoor, dry location only. This device is not intended for use with emergency exit fixtures or emergency exit lights. May not be compatible with all dimmers; please visit solais.com/dimming for up-to-date dimmer compatibility information.

NOTES: This device complies with Part 15 of the FCC Rule. This product may cause interference with other devices. If interference occurs, change the locations of the products involved. **Compatible on 120v systems.**

