

PROJECT \_\_\_\_\_ TYPE \_\_\_\_\_

MEMO \_\_\_\_\_

ORDERING CODE BREAKDOWN

### MAIN FEATURES

- Designed with a die-cast, aluminum alloy housing for optimal thermal performance and exceptional corrosion resistance
- Delivering up to 170 lumens per watt
- 3,000- to 20,000 lumen packages (20-160W)
- Extended site arm offers universal mounting, allowing for retrofit without drilling into existing poles
- All mounting options allow for multiple fixture installations at 90°
- TGIC polyester super durable powder coating with superior gloss, color retention, and weather resistance
- 0-10V dimming standard; DALI-2 dimming option available
- BAA Compliance available; *Consult factory to confirm specific fixture code is compliant if this is a requirement*
- **Designed and assembled in U.S.A.!**



Extended Site Arm  
EPA: 0.56 sq. ft.  
WEIGHT: 14.33 lbs.



FIXTURE	LUMENS	BEAM SPREAD	CRI	CCT	VOLTAGE	CONTROLS	SURGE	PHOTOCELL RECEPTACLE	FINISH	MOUNTING	FIXTURE OPTIONS	ADAPTER OPTIONS	FIELD OPTIONS	
GL1	3H : 3,000 lm; 21W	2RM : Type II Roadway Medium	7 : 70 CRI	30 : 3000K	STD : 120-277V	10 : 0-10V	1PS : 10kV 5kA, 120-277V	00 : None	SBZ : Bronze (RAL8019)	ES : Extended Site Arm	ZT1 : 0-10V Z Ambient Light Control	RP : Site Arm Round Pole Adapter	SOL28 HSS : House-side Shield	
	4H : 4,000 lm; 25W	3RM : Type III Roadway Medium	8 : 80 CRI	40 : 4000K	HVL : 277-480V	DA : DALI-2 D4i	2PS : *20kV 10kA, 120-277V	70 : 7-pin	SGY : Gray (RAL7038)	HT : Horizontal Tenon	ZT3 : 0-10V Z IR + Ambient Light Control	SMCB : Wall Pack Surface Mount Conduit Box	SOL28 FSS : Front-side Shield	
	5H : 5,000 lm; 32W	3AM : Type III Area Medium		50 : 5000K				2PH : *20kV 10kA, 277-480V	0Z : Z receptacle	SWH : White (RAL9003)	KM : 3" OD Knuckle Mount	ZT4 : 0-10V Z Occupancy + IR + Ambient Light Control	ERP : Extended Site Arm Round Pole Adapter	SOL28 CSS : Cul-de-Sac Shield
	6H : 6,000 lm; 42W	4WS : Type IV Wide Short							7Z : 7-pin + Z	SBK : Black (RAL9017)	WP : Wall Pack	ZT5 : 0-10V Z Casambi Bluetooth Mesh Node		SOL28 SS : Scoop Shield
	7H : 7,000 lm; 52W	5QS : Type V Square Short								*MBZ : Marine Bronze				PCL-01 : 120-277V Photocell
	8H : 8,000 lm; 60W	5QM : Type V Square Medium								*MGY : Marine Grey				PCL-02 : 120-277V Photocell
	9H : 9,000 lm; 65W									*MWH : Marine White				PCL-03 : 347-480V Photocell
	11H : 11,000 lm; 80W									*MBK : Marine Black				PCL-04 : 347-480V Photocell (Midnight Dim)
	12H : 12,000 lm; 89W													PCL-05 : 120-277V Photocell (Midnight Dim)
	14H : 14,000 lm; 112W													ENL-SC1 : Shorting Cap
	16H : 15,000 lm; 131W													
	16P : 16,000 lm; 123W													
	18P : 18,000 lm; 143W													
	20P : 20,000 lm; 164W													

Notes: Consult factory to verify BAA compliant products. HSS not compatible with 4WS optics, instead use SS. 80 or 90 CRI, + additional CCTs available upon request

\*Consult factory for lead time and availability. HVL unavailable with ZT1, ZT3, ZT4 and ZT5 photocell receptacles. ZT1 - ZT5 options only available with 10 : 0-10V Dimming

### FINISH

- TGIC polyester super-durable powder coating with superior gloss, color retention and weather resistance
- Standard finishes provided at 3 mil nominal thickness, salt-spray-tested to 3,000 hours as per ASTM B117
- For marine-grade finish, consult factory. Provided at 5 mil nominal thickness, salt-spray-tested to 4,000 hours as per ASTM B117

### MOUNTING

- Extended site arm offers universal mounting, allowing for retrofit without drilling into existing poles
- Options allow for multiple fixture installations at 90°
- Wall-mount and round pole adapters are available for extended site arm

### CONSTRUCTION

- Die-cast, aluminum alloy housing for optimal thermal performance and exceptional corrosion resistance
- 100% recycled aluminum

### ELECTRICAL

- 120-277V Standard; 277-480V option available
- PF>0.9, THD<20%
- Parallel surge protection: enhanced 10kV standard, extreme 20kV optional (ANSI C136.2-2015)
- For series surge protection, consult factory
- Rated for operation -40°C to 40°C
- For 50°C option, consult factory

### OPTICS + PERFORMANCE

- Up to 170 lumens per watt
- 3,000- to 20,000 lumen packages (20-160W)
- 5 customized distributions available
  - Type II Roadway Medium (Coefficient of Utilization: 0.793)
  - Type III Roadway Medium (Coefficient of Utilization: 0.852)
  - Type IV Wide Short (Coefficient of Utilization: 0.840)
  - Type V Square Short
  - Type V Square Medium
- Multiple shielding options available

### CONTROLS

- 0-10V dimming standard; DALI-2 option available
- Receptacle options:
  - ANSI C136.41 3-pin
  - ANSI C136.41 7-pin (for DALI-2 or 0-10 V dimming)
  - Zhaga Book 18 (for next generation ambient light/motion sensing)

### LISTINGS

- IP66-rated optical and electrical chambers
- 3G Vibration-rated (ANSI C136.31)
- cULus Listed for wet locations
- IDA Dark Sky listed with ≤3000K (Site Arm, Horizontal Tenon)
- Zhaga D4i listed
- ANSI C136.15 labeling available
- BAA Compliance available; *Consult factory to confirm specific fixture code is compliant if this is a requirement*
- **Designed and assembled in U.S.A.**

### WARRANTY

- 5-year warranty

### Extended Site Arm (ES)

- Universal mount adapter
- Allows for retrofit without drilling into existing poles

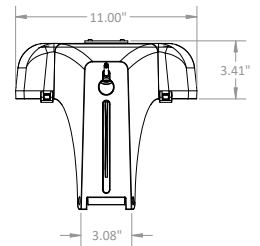
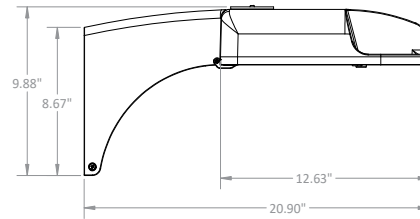
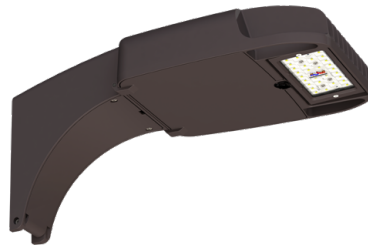

### Horizontal Tenon (HT)

- Mounts to maximum 2 3/4" O.D. tenon

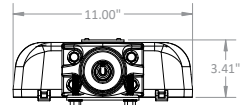
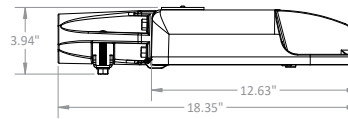

### Knuckle (KM)

- Mounts to maximum 3" O.D. tenon
- Adjustable at 7.5° increments
- Not recommended to angle luminaire past 0° (vertical); maintain downward angle

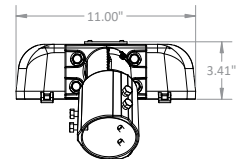
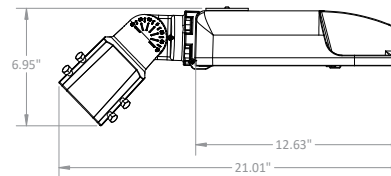

### Wall Pack (WP)

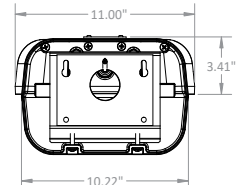
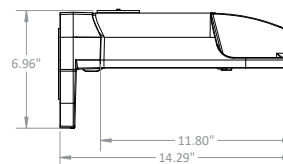

### Wall Pack (WP) - SMBC (field installed option)

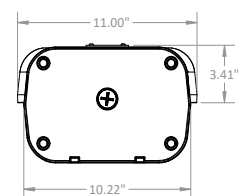
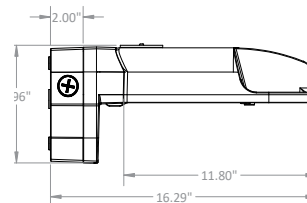

PROJECT \_\_\_\_\_

TYPE \_\_\_\_\_

## LED GRIDLITE (GEN 2) SITE LIGHT FIXTURE

### LUMEN AMBIENT TEMPERATURE (LAT) MULTIPLIERS

Ambient Temperature		Lumen Multiplier
Celsius	Fahrenheit	
0°C	32°F	1.02
10°C	50°F	1.01
25°C	77°F	1.00
40°C	104°F	0.99
50°C	122°F	0.97

### TM-21 LUMEN MAINTENANCE PROJECTION









Calculated by utilizing the LED manufacturer's LM80 test data in conjunction with third party verified in-situ LED drive current and LED temperature data. Use data below to determine light loss factors.

50,000 hrs	60,000 hrs	100,000 hrs
99.67%	99.49%	98.77%

### WEIGHTS + EPA INFORMATION

Mounting Type	Weight		
	Below 9H	11H to 15H	Above 16H
Extended Site Arm (ES)	14.33 lbs.	16.02 lbs.	16.48 lbs.
Horizontal Tenon (HT)	12.76 lbs.	14.45 lbs.	14.91 lbs.
Knuckle Mount (KM)	12.77 lbs.	14.46 lbs.	14.92 lbs.
Wall Pack (WP)	13.19 lbs.	14.88 lbs.	15.34 lbs.
Wall Pack (WP) with SMBC	15.40 lbs.	17.09 lbs.	17.55 lbs.

\* Data below includes luminaire and integrated mounting option. Additional tenons, arms and brackets are not included.

Mounting Type	Tilt	Single	2 at 90°	2 at 180°	2 at 120°	3 at 90°	3 at 120°	4 at 90°	2 Side-by-Side
									
Extended Site Arm (ES)	n/a	0.56 sq. ft.	0.98 sq. ft.	1.11 sq. ft.	1.24 sq. ft.	1.53 sq. ft.	1.66 sq. ft.	1.53 sq. ft.	0.84 sq. ft.
Extended Site Arm (ES) with Round Pole Adapter (ERP)	n/a	0.60 sq. ft.	1.01 sq. ft.	1.19 sq. ft.	1.28 sq. ft.	1.61 sq. ft.	1.70 sq. ft.	1.61 sq. ft.	0.84 sq. ft.
Horizontal Tenon (HT)	n/a	0.40 sq. ft.	0.65 sq. ft.	0.80 sq. ft.	0.82 sq. ft.	1.05 sq. ft.	1.07 sq. ft.	1.05 sq. ft.	0.50 sq. ft.
Knuckle Mount (KM) (7.5° increments)	90° (horizontal)	0.47 sq. ft.	0.81 sq. ft.	0.94 sq. ft.	0.94 sq. ft.	1.28 sq. ft.	1.28 sq. ft.	1.28 sq. ft.	0.69 sq. ft.
	60°	0.47 sq. ft.	1.12 sq. ft.	0.94 sq. ft.	1.42 sq. ft.	1.59 sq. ft.	2.07 sq. ft.	1.59 sq. ft.	1.30 sq. ft.
	45°	0.47 sq. ft.	1.30 sq. ft.	0.94 sq. ft.	1.70 sq. ft.	1.77 sq. ft.	2.53 sq. ft.	1.77 sq. ft.	1.67 sq. ft.
	30°	0.47 sq. ft.	1.43 sq. ft.	0.94 sq. ft.	1.94 sq. ft.	1.90 sq. ft.	2.90 sq. ft.	1.90 sq. ft.	1.92 sq. ft.
	0° (vertical)	0.47 sq. ft.	1.53 sq. ft.	0.94 sq. ft.	2.08 sq. ft.	2.00 sq. ft.	3.14 sq. ft.	2.00 sq. ft.	2.12 sq. ft.

### PHOTOMETRIC DISTRIBUTION

TYPE II ROADWAY MEDIUM (2RM)

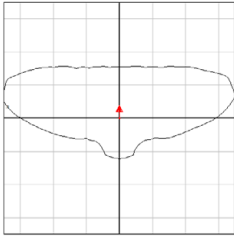

TYPE III ROADWAY MEDIUM (3RM)

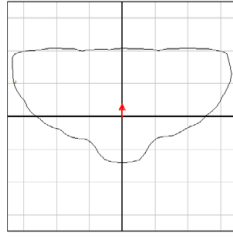

TYPE IV WIDE SHORT (4WS)

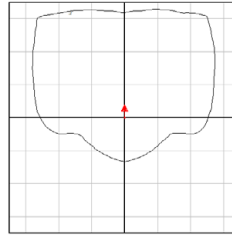

TYPE V SQUARE SHORT (5QS)

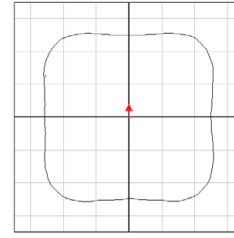

TYPE V SQUARE MEDIUM (5QM)

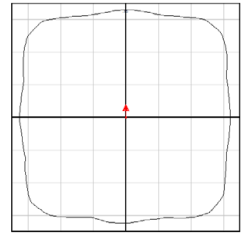

### SHIELD ACCESSORY DETAILS

#### HOUSE SIDE SHIELD (HSS)

- Flat-black, injection molded plastic resin
- Tool-less, clip-on discrete shield
- Blocks light behind the fixture



#### CUL-DE-SAC SHIELD (CSS)

- Flat-black, injection molded plastic resin
- Tool-less, clip-on discrete shield
- Blocks light to left and right of the fixture

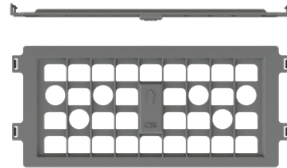

#### FRONT SIDE SHIELD (FSS)

- Flat-black, injection molded plastic resin
- Tool-less, clip-on discrete shield
- Blocks light in front of the fixture.

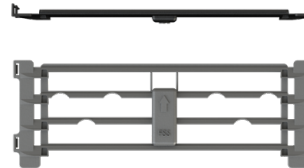

#### SCOOP SHIELD (SS)

- Flat-black, injection-molded plastic resin
- Tool-less, clip-on discrete shield
- Blocks light behind the fixture (4WS only)



### CONTROLS

#### 0-10 V ZHAGA OPTIONS

- ZT1: Ambient Light Control
- ZT3: IR + Ambient Light Control
- ZT4: Occupancy + IR + Ambient Light Control
- ZT5: 0-10V Zhaga Casambi BLE + ALC



#### PHOTOCELL OPTIONS

- PCL01: 120-277V Photocell (640J, IP65); Blue
- PCL02: 120-277V Photocell (1280J, IP66); Blue
- PCL03: 347-480V Photocell (1280J, IP66); Yellow
- PCL04: 50% Midnight Dimming, 347-480V Photocell (1280J, IP65); Brown
- PCL05: 50% Midnight Dimming, 120-277V Photocell (1280J, IP65); Brown

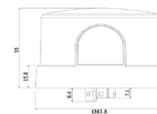

PROJECT \_\_\_\_\_

TYPE \_\_\_\_\_

## LED GRIDLITE (GEN 2) SITE LIGHT FIXTURE

Performance Package	Wattage Label	Drive Current	Color Temp. (CCT)	Input Power (Watts)	TYPE II ROADWAY MED (2RM) AT 70 CRI			TYPE III ROADWAY MED (3RM) AT 70 CRI			TYPE III AREA MED (3AM) AT 70 CRI			TYPE IV WIDE SHORT (4WS) AT 70 CRI			TYPE V SQUARE SHORT (5QS) AT 70 CRI			TYPE V SQUARE MED (5QM) AT 70 CRI		
					Lumens	Efficacy (lm/W)	BUG Rating	Lumens	Efficacy (lm/W)	BUG Rating	Lumens	Efficacy (lm/W)	BUG Rating	Lumens	Efficacy (lm/W)	BUG Rating	Lumens	Efficacy (lm/W)	BUG Rating	Lumens	Efficacy (lm/W)	BUG Rating
3H	20	250mA	5000K	21.0	3,590	171	1 0 1	3,601	171	1 0 1				3,418	162	1 0 1	3,605	171	2 0 1	3,470	165	2 0 1
			4000K		3,555	169	1 0 1	3,565	170	1 0 1				3,384	161	1 0 1	3,569	170	2 0 1	3,436	163	2 0 1
			3000K		3,412	162	1 0 1	3,423	163	1 0 1				3,248	154	1 0 1	3,426	163	2 0 1	3,298	157	2 0 1
4H	30	300mA	5000K	25.4	4,291	169	1 0 1	4,305	169	1 0 1				4,085	161	1 0 1	4,309	169	2 0 1	4,148	163	2 0 1
			4000K		4,249	167	1 0 1	4,262	168	1 0 1				4,045	159	1 0 1	4,266	168	2 0 1	4,107	161	2 0 1
			3000K		4,079	160	1 0 1	4,091	161	1 0 1				3,883	153	1 0 1	4,096	161	2 0 1	3,943	155	2 0 1
5H	30	375mA	5000K	32.6	5,357	164	1 0 1	5,373	165	1 0 1				5,099	156	1 0 2	5,379	165	2 0 1	5,178	159	3 0 1
			4000K		5,304	163	1 0 1	5,320	163	1 0 1				5,049	155	1 0 1	5,325	163	2 0 1	5,127	157	3 0 1
			3000K		5,092	156	1 0 1	5,107	157	1 0 1				4,847	149	1 0 1	5,112	157	2 0 1	4,922	151	3 0 1
6H	40	483mA	5000K	42.7	6,775	159	1 0 1	6,796	159	1 0 2				6,450	151	1 0 2	6,803	159	3 0 1	6,549	153	3 0 1
			4000K		6,708	157	1 0 1	6,729	158	1 0 1				6,386	149	1 0 2	6,736	158	3 0 1	6,484	152	3 0 1
			3000K		6,440	151	1 0 1	6,459	151	1 0 1				6,131	144	1 0 2	6,466	151	3 0 1	6,225	146	3 0 1
7H	50	585mA	5000K	52.5	8,009	152	1 0 2	8,033	153	1 0 2				7,624	145	1 0 2	8,042	153	3 0 2	7,742	147	3 0 2
			4000K		7,930	151	1 0 2	7,954	151	1 0 2				7,549	144	1 0 2	7,962	152	3 0 2	7,665	146	3 0 2
			3000K		7,612	145	1 0 2	7,635	145	1 0 2				7,247	138	1 0 2	7,643	146	3 0 1	7,358	140	3 0 2
8H	60	672mA	5000K	61.2	9,024	147	1 0 2	9,051	148	1 0 2				8,590	140	1 0 2	9,061	148	3 0 2	8,722	143	3 0 2
			4000K		8,934	146	1 0 2	8,961	146	1 0 2				8,505	139	1 0 2	8,971	147	3 0 2	8,636	141	3 0 2
			3000K		8,577	140	1 0 2	8,603	141	1 0 2				8,165	133	1 0 2	8,612	141	3 0 2	8,291	136	3 0 2
9H	70	725mA	5000K	66.2	9,565	145	2 0 2	9,594	145	1 0 2				9,106	138	1 0 2	9,604	145	3 0 2	9,246	140	3 0 2
			4000K		9,470	143	2 0 2	9,499	144	1 0 2				9,016	136	1 0 2	9,509	144	3 0 2	9,154	138	3 0 2
			3000K		9,092	137	1 0 2	9,119	138	1 0 2				8,655	131	1 0 2	9,129	138	3 0 2	8,788	133	3 0 2
11H	80	924mA	5000K	81.5	11,692	143	2 0 2	11,728	144	1 0 2				11,131	137	2 0 2	11,740	144	3 0 2	11,302	139	4 0 2
			4000K		11,577	142	2 0 2	11,612	142	1 0 2				11,021	135	2 0 2	11,624	143	3 0 2	11,190	137	4 0 2
			3000K		11,114	136	2 0 2	11,147	137	1 0 2				10,580	130	1 0 2	11,159	137	3 0 2	10,743	132	4 0 2
12H	90	1029mA	5000K	90.8	12,641	139	2 0 2	12,679	140	1 0 2				12,034	133	2 0 2	12,693	140	3 0 2	12,219	135	4 0 2
			4000K		12,516	138	2 0 2	12,554	138	1 0 2				11,915	131	2 0 2	12,567	138	3 0 2	12,098	133	4 0 2
			3000K		12,015	132	2 0 2	12,052	133	1 0 2				11,438	126	2 0 2	12,064	133	3 0 2	11,614	128	4 0 2
14H	110	1281mA	5000K	114.6	14,840	129	2 0 2	14,885	130	2 0 2				14,127	123	2 0 3	14,901	130	4 0 2	14,345	125	4 0 2
			4000K		14,693	128	2 0 2	14,738	129	2 0 2				13,987	122	2 0 2	14,753	129	4 0 2	14,203	124	4 0 2
			3000K		14,105	123	2 0 2	14,148	123	2 0 2				13,428	117	2 0 2	14,163	124	3 0 2	13,634	119	4 0 2
16H	130	1449mA	5000K	130.8	16,101	123	2 0 2	16,150	124	2 0 2				15,328	117	2 0 3	16,167	124	4 0 2	15,563	119	4 0 2
			4000K		15,941	122	2 0 2	15,990	122	2 0 2				15,176	116	2 0 3	16,007	122	4 0 2	15,409	118	4 0 2
			3000K		15,304	117	2 0 2	15,350	117	2 0 2				14,569	111	2 0 3	15,366	118	4 0 2	14,793	113	4 0 2
16P	120	1365mA	5000K	122.9	16,387	133	3 0 3	16,434	134	2 0 2	15,756	128	2 0 2	15,202	124	2 0 2	16,278	132	2 0 2	15,389	125	4 0 2
			4000K		16,225	132	3 0 3	16,271	132	2 0 2	15,600	127	2 0 2	15,051	122	2 0 2	16,117	131	2 0 2	15,237	124	4 0 2
			3000K		15,576	127	3 0 3	15,620	127	2 0 2	14,976	122	2 0 2	14,449	118	2 0 2	15,472	126	2 0 2	14,628	119	4 0 2
18P	140	1608mA	5000K	143.2	18,151	127	3 0 3	18,203	127	2 0 2	17,452	122	3 0 3	16,838	118	3 0 3	18,030	126	3 0 3	17,046	119	4 0 2
			4000K		17,972	125	3 0 3	18,023	126	2 0 2	17,280	121	3 0 3	16,672	116	3 0 3	17,852	125	3 0 3	16,877	118	4 0 2
			3000K		17,253	120	3 0 3	17,302	121	2 0 2	16,588	116	2 0 3	16,005	112	2 0 3	17,138	120	2 0 2	16,202	113	4 0 2
20P	160	1709mA	5000K	164.4	19,771	120	3 0 3	19,827	121	2 0 3	19,010	116	3 0 3	18,341	112	3 0 3	19,639	119	3 0 3	18,567	113	4 0 2
			4000K		19,575	119	3 0 3	19,631	119	2 0 2	18,822	114	3 0 3	18,159	110	3 0 3	19,445	118	3 0 3	18,383	112	4 0 2
			3000K		18,792	114	3 0 3	18,846	115	2 0 2	18,069	110	3 0 3	17,433	106	3 0 3	18,667	114	3 0 3	17,648	107	4 0 2

### POLE INFORMATION

• Solais offers a full line of aluminum and steel poles, brackets and accessories for your installation. For more information, consult factory.

#### SQUARE STRAIGHT

- 8- to 39-ft. height options

#### ROUND STRAIGHT

- 8- to 35-ft. height options

#### SQUARE TAPERED

- 20- to 50-ft. height options

#### ROUND TAPERED

- 8- to 39-ft. height options
- 45- to 70-ft. telescoping height options

#### HINGED TAPERED

- 20- to 39-ft. height options

