



IMPORTANT: Read **ALL** instructions before starting installation. Save instructions for later use.
CAUTION: To reduce risk of shock, **TURN OFF ELECTRICAL SUPPLY** before installing/servicing track.
WARNING: **TRACK** must be installed with its intended use and in accordance of National Electrical Code (NEC) and/or any local codes. *Failure to do so may result in serious injury and/or damage.*

Recommended Tools

Screw Driver



Wire Stripper



Wing Nuts



Safety Instructions

- Observe and follow all label information and instructions regarding dry, damp and wet location listings, proper lamp type and wattage, warnings of installation near combustible materials and/or insulation.
- Turn off power at circuit breaker before attempting to install or perform maintenance on the fixtures.
- Be sure to connect ground wire to prevent electric shock or other potential hazards.
- The product must be installed in a manner consistent with the intended use and in compliance with the national electrical codes and local codes.
- Do not block the trim aperture as this may cause unsafe operating conditions.
- **WARNING: RISK OF FIRE.** Most dwellings built before 1985 have supply wire rated for 60°C. Consult a qualified electrician before installation. The fixture must be connected with supply wire rated for at least 75°C.
- Use only Solais Lighting trims listed for use with this fixture. Use of trims other than those listed by Solais Lighting is a violation of N.E.C 110-3(B) and voids all warranties. Use **ONLY** with proper Solais Lighting modules.



ADAPTER PLATE

- Determine what aperture size and type will be used on the tray:
 - ST2Arm = Attach ST2Arm Adapter Plate (5008-000545)
 - ST3Arm = Attach ST3Arm Adapter Plate (5008-000544)
 - ST4ARM = No Adapter Plate needed

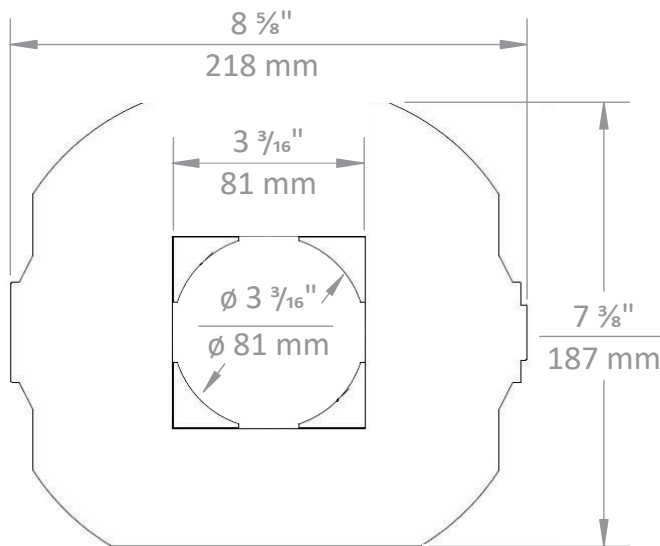

5008-000545
ST2ARM ADAPTER PLATE

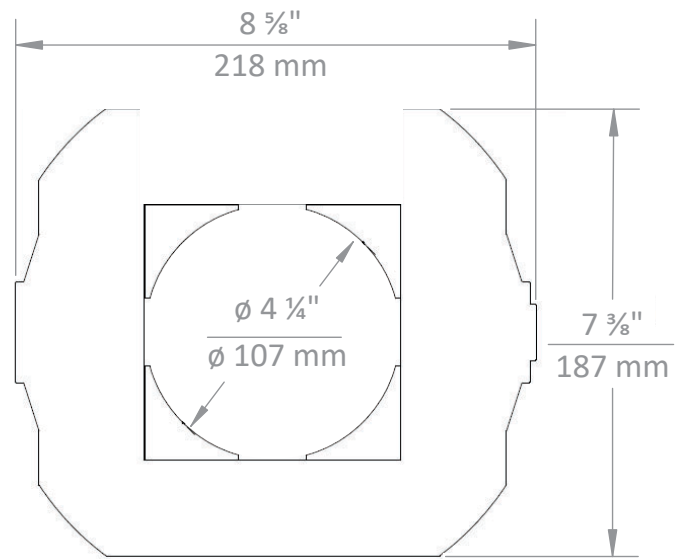

5008-000544
ST3ARM ADAPTER PLATE

- Connect the adapter plate tab side into the tray slot.
- Press the other side of the plate down into the tray. The press-fit tray tab holds it in place.

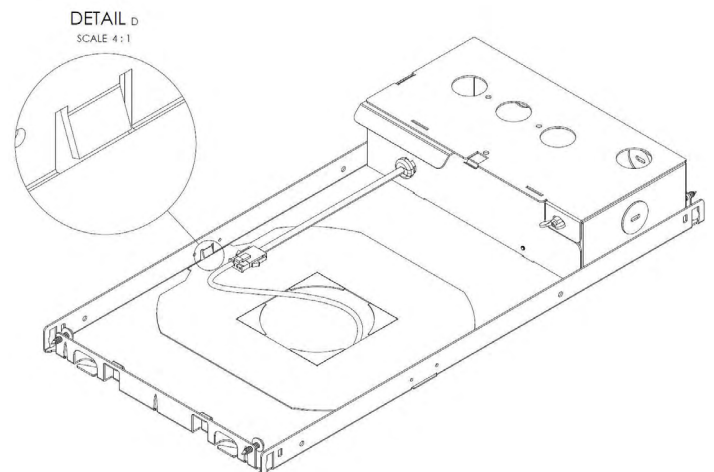
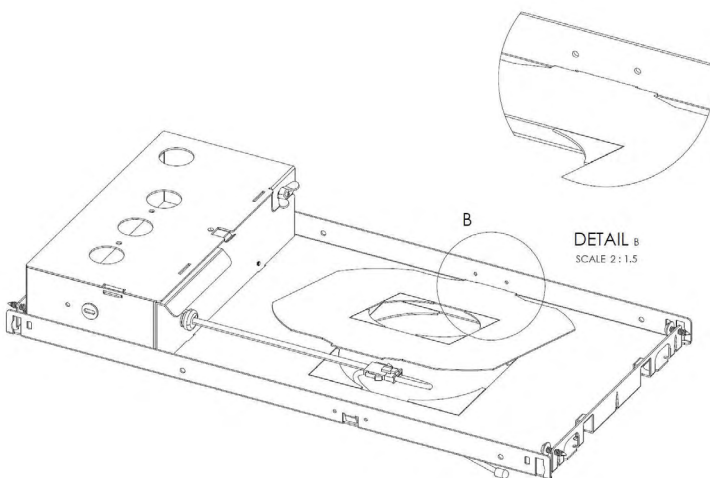

TRAY ASSEMBLY

- Install the Mounting Bars into the Construction Tray Assembly based on the tray type:

New Construction Tray (NCT), No Housing

- Secure both ends of the mounting bars through the slots in the Construction Tray.

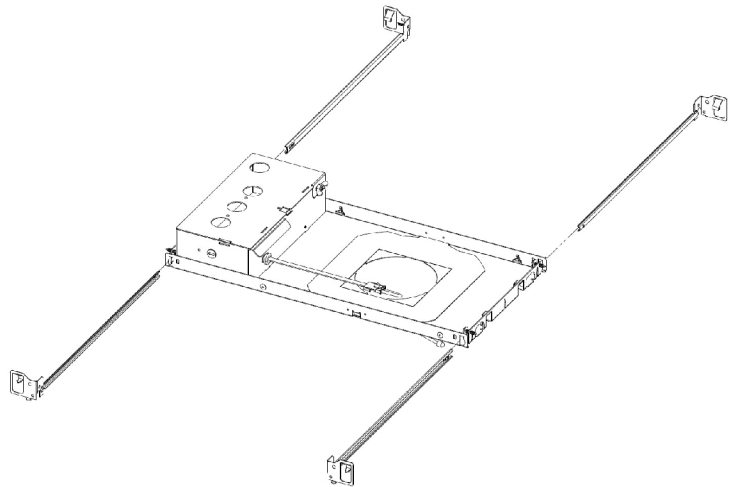

New Construction Housing (NCH), No Vertical Mounting Brackets

- Connect both ends of the mounting bars through the slots in the Construction Tray.

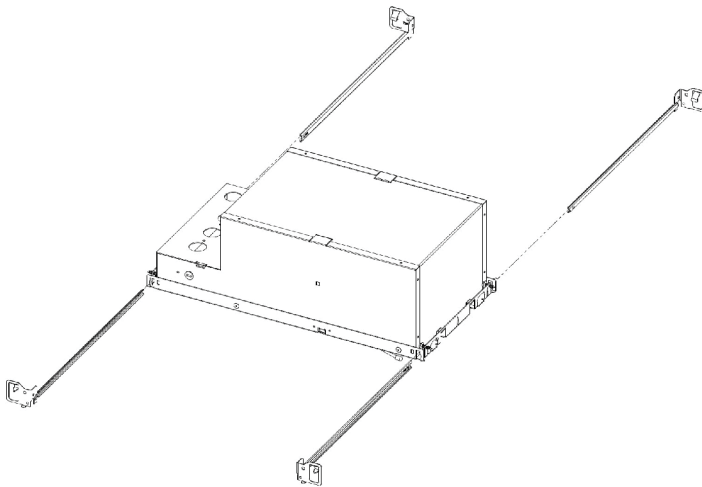

New Construction Housing (NCH) and Vertical Mounting Brackets

- Connect both ends of the mounting bars through the slots in the Vertical Mounting Brackets

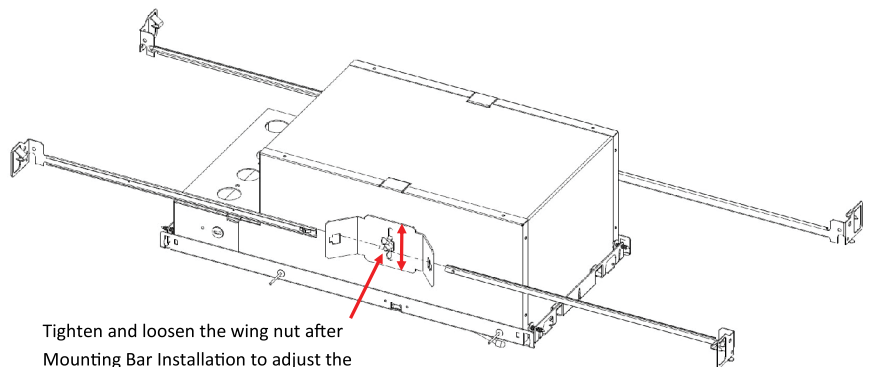

Tighten and loosen the wing nut after Mounting Bar Installation to adjust the vertical position of the Mounting Bars

MOUNTING BARS

- Verify that the Mounting Bar Screws in the Construction Tray are correctly tightened to prevent play between Mounting Bars and Tray.
- **Omit this step if you are using the Vertical Mounting Brackets.**

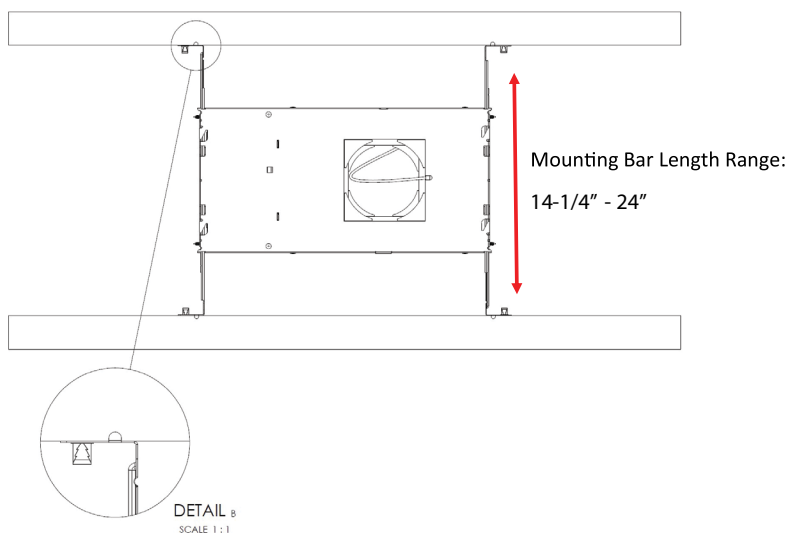
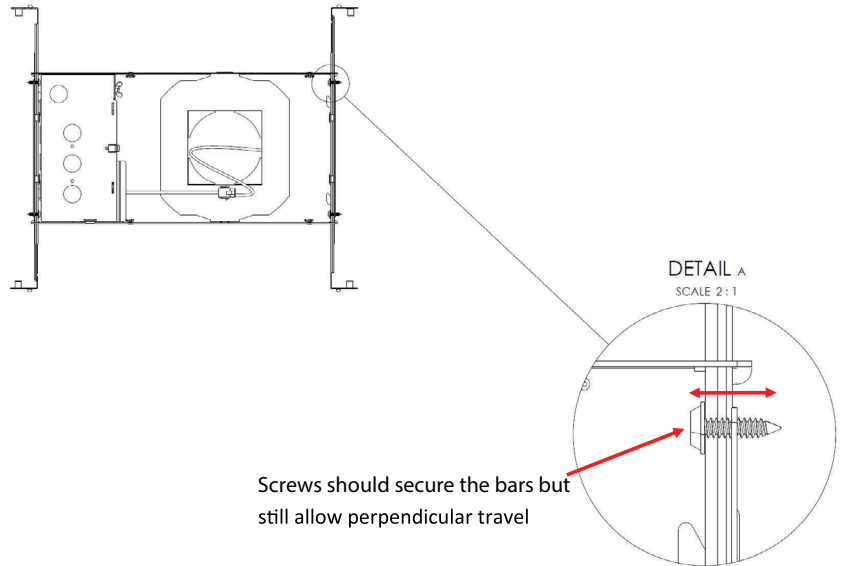

- After the Mounting Bars are installed, adjust the length of the Mounting Bars to match the width of the Ceiling Joist spacing.
- **Make sure the bottom half-circle tabs of the Mounting Bars are lined up with the bottom of the Ceiling Joists.**

MOUNTING BARS

- Press the integral nails into the joists to fully secure the Mounting Bars. Auxiliary nail/screw holes are included as well for extra security.

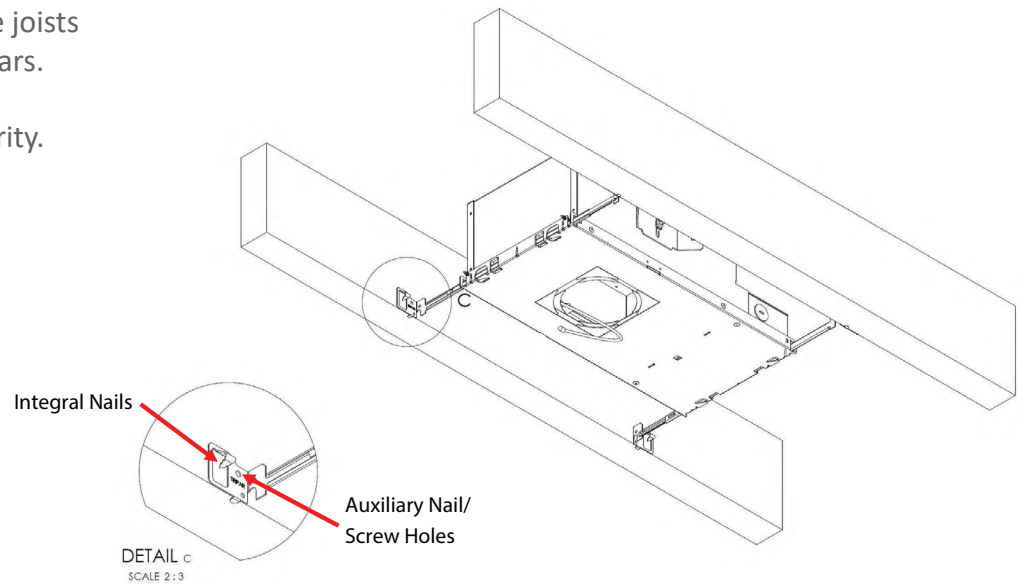

- Make branch circuit connections through the knockout holes of the Construction Tray Junction Box. Use the strain relief connectors provided by others.

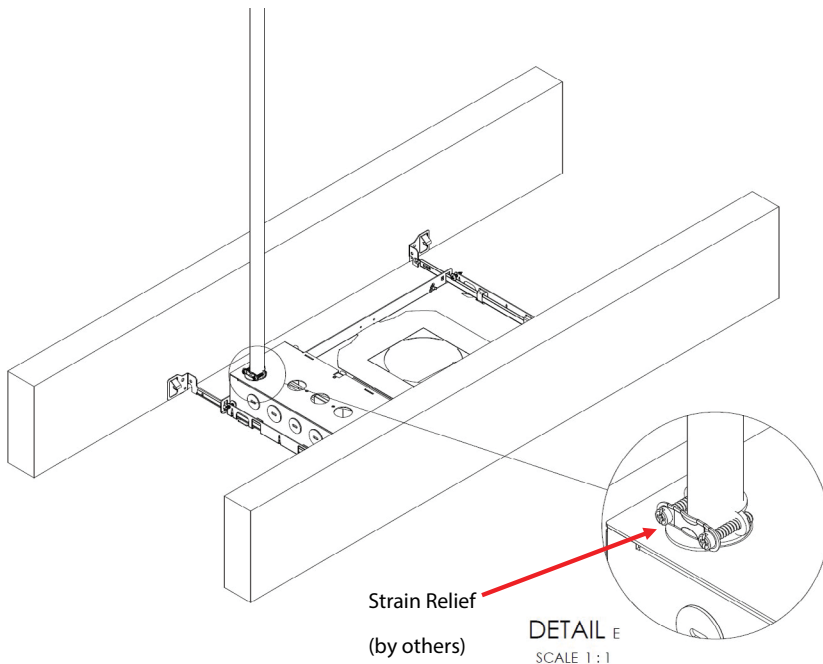

CEILING CUTOUT + COLLAR INSTALLATION

- Cut the ceiling cutout based on the STXARM fixture type being installed.

Replace the ceiling panel:

- ST2Arm-R: Ø 3 1/8" Circle
- ST2Arm-S: 3 1/8" x 3 1/8" Square
- ST3Arm-R: Ø 4 1/8" Circle
- ST3Arm-S: 4 1/8" x 4 1/8" Square
- ST4ARM-R: Ø 4 7/8" Circle
- ST4ARM-R: 4 7/8" x 4 7/8" Square

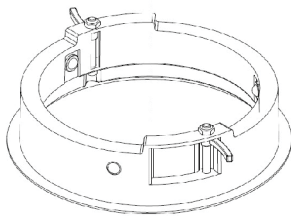
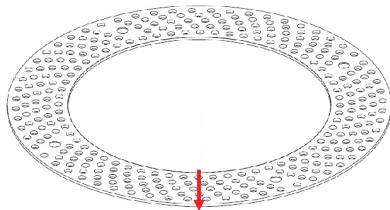

- Tuck collar wings towards the collar to fit the collar inside the ceiling cutout from below.

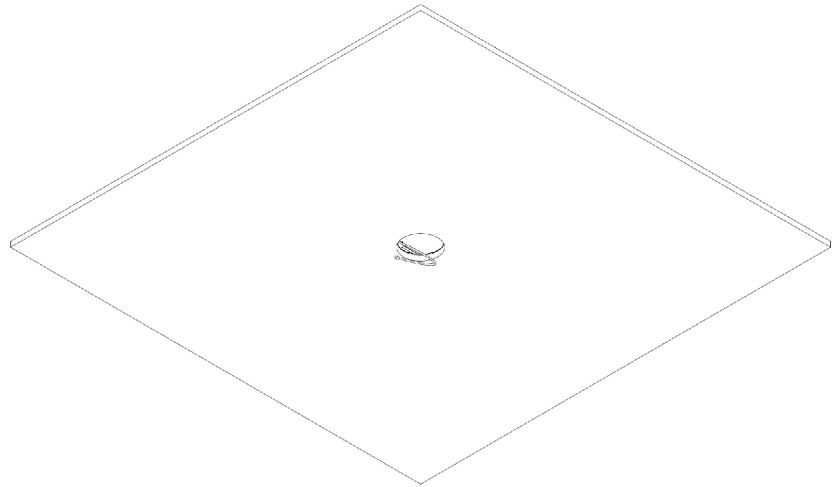

- For Trimless applications, the mud flange must be placed onto the collar before installation so that it is compressed between the collar and the ceiling panel.
- **Omit this step if this is not a Trim-less application.**

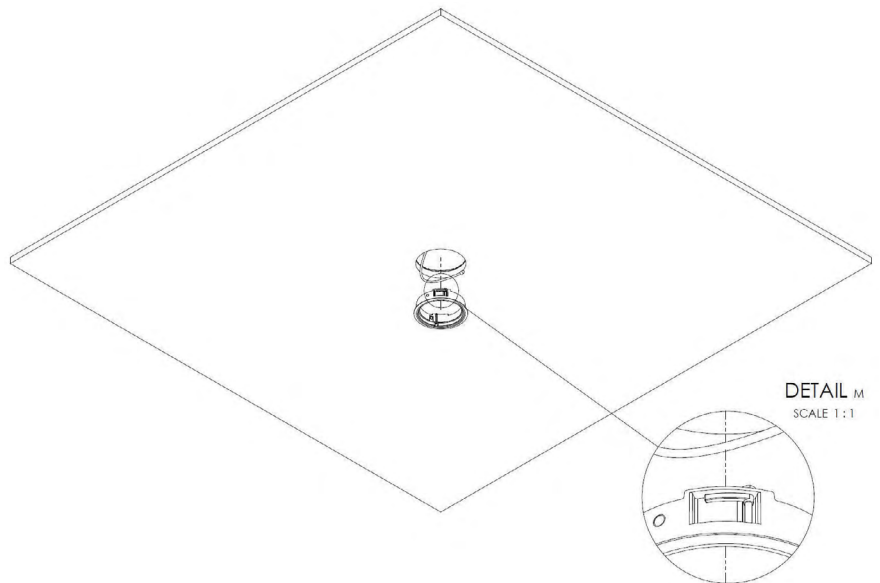

DETAIL M
SCALE 1:1

COLLAR INSTALLATION

- Install the collar into the ceiling by fastening the collar wing screws from below the ceiling in a **clockwise** direction with a screwdriver. The collar wings will pop out and secure the collar to the ceiling.

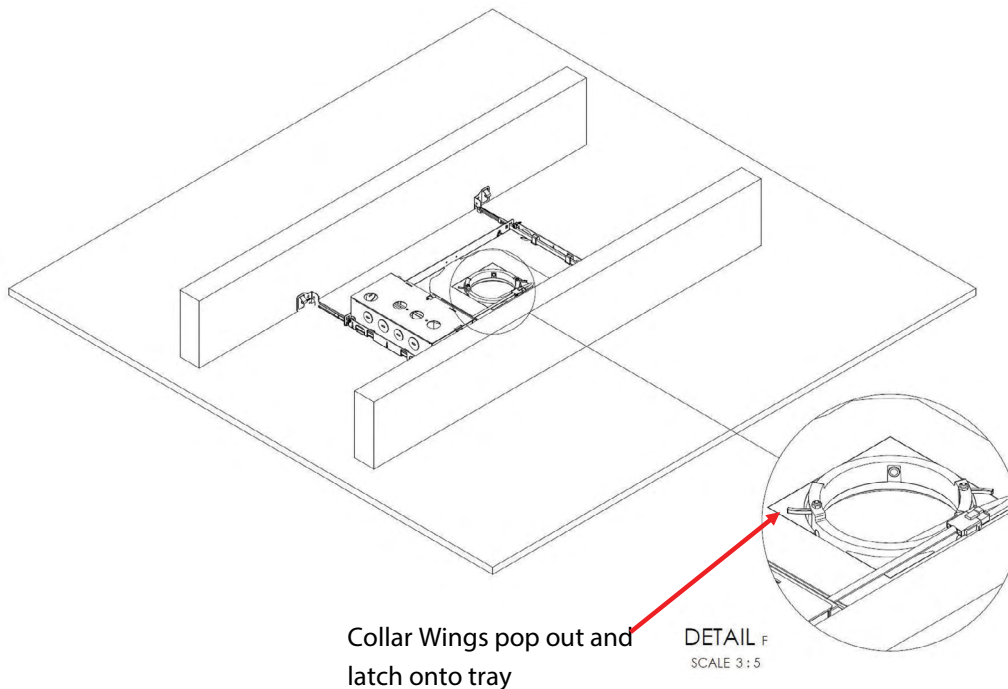
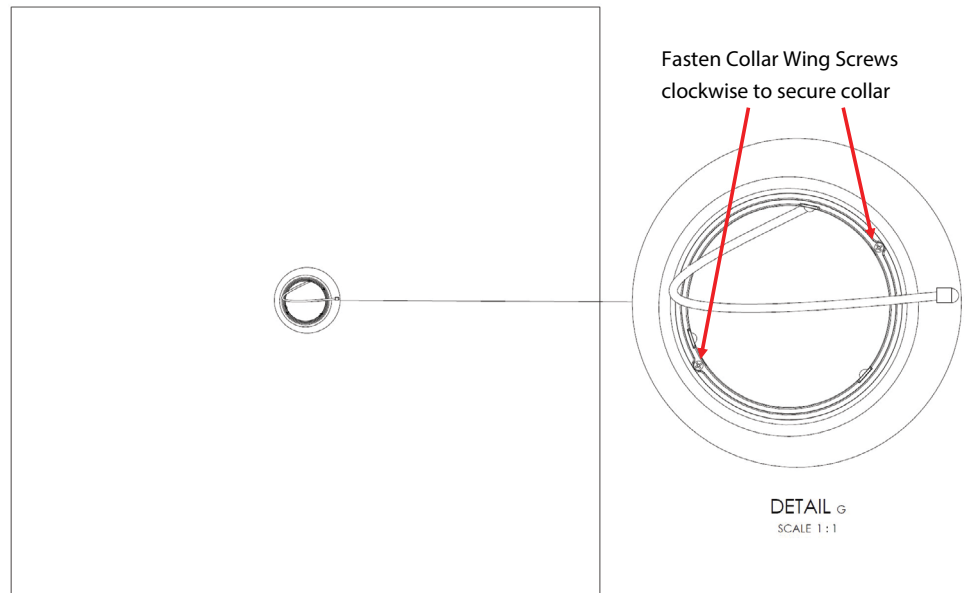

LED INSTALLATION INDICATOR

- Disconnect the LED installation indicator connected to the Construction Tray.
- Discard the indicator after it is removed. This can be done through the collar aperture.

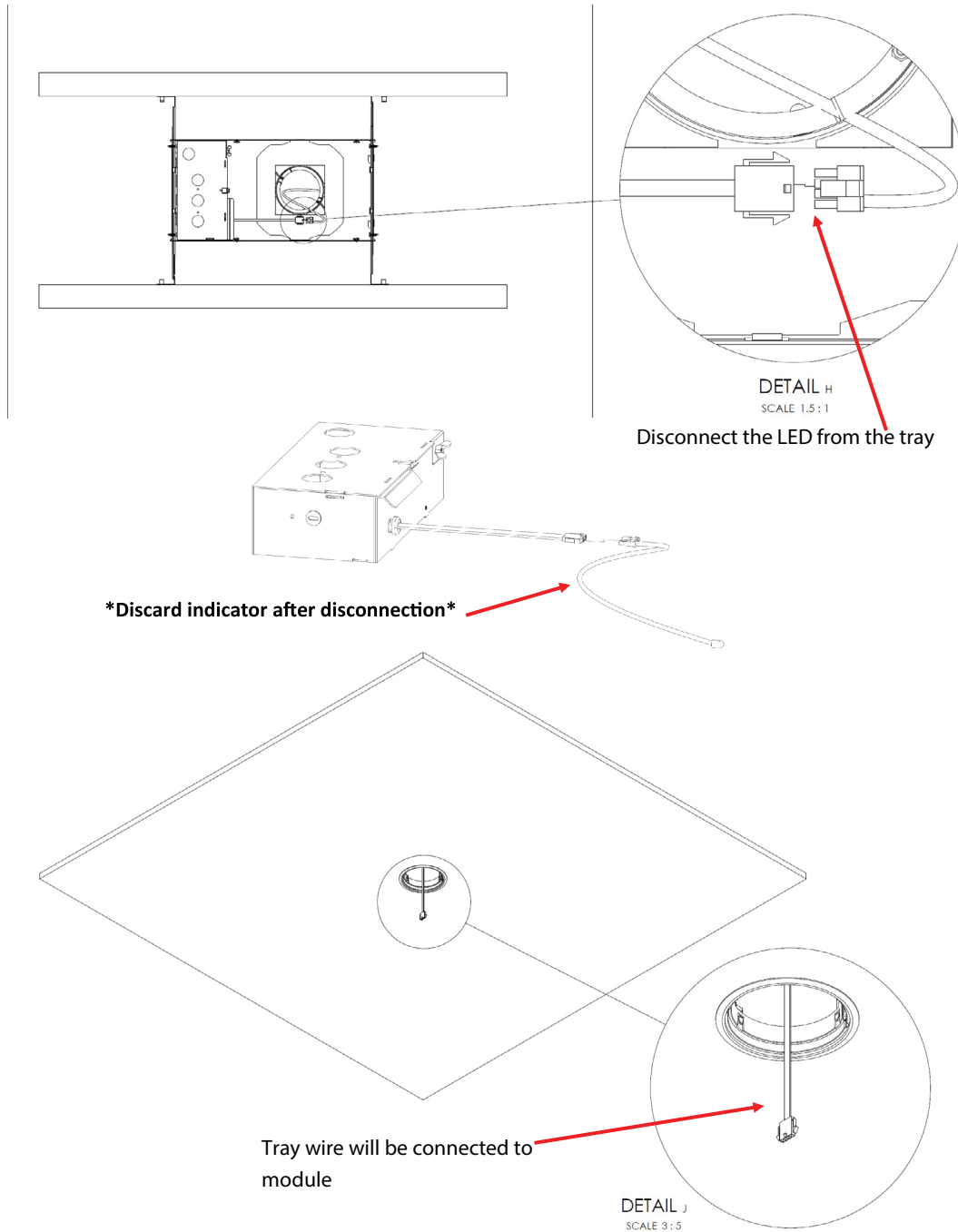

MODULE INSTALLATION

- Connect the tray wire to the module wire through the aperture from below the ceiling.

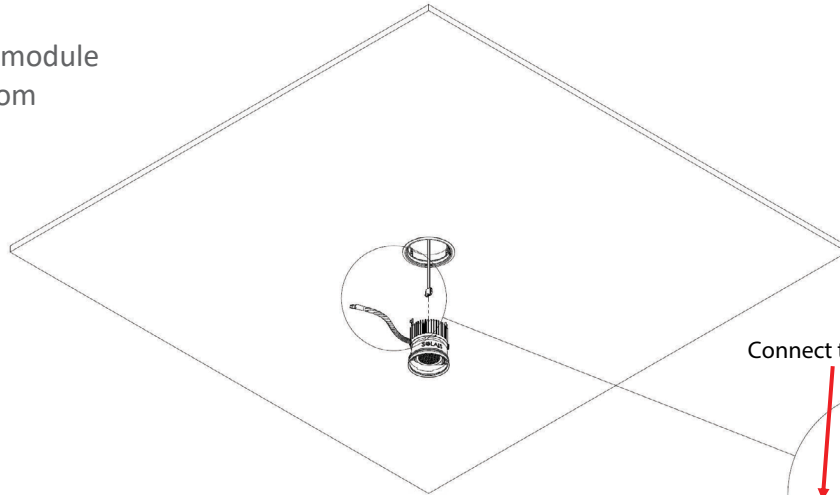

Connect the tray to the module

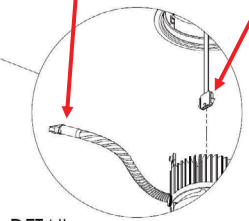

DETAIL K
SCALE 2:5

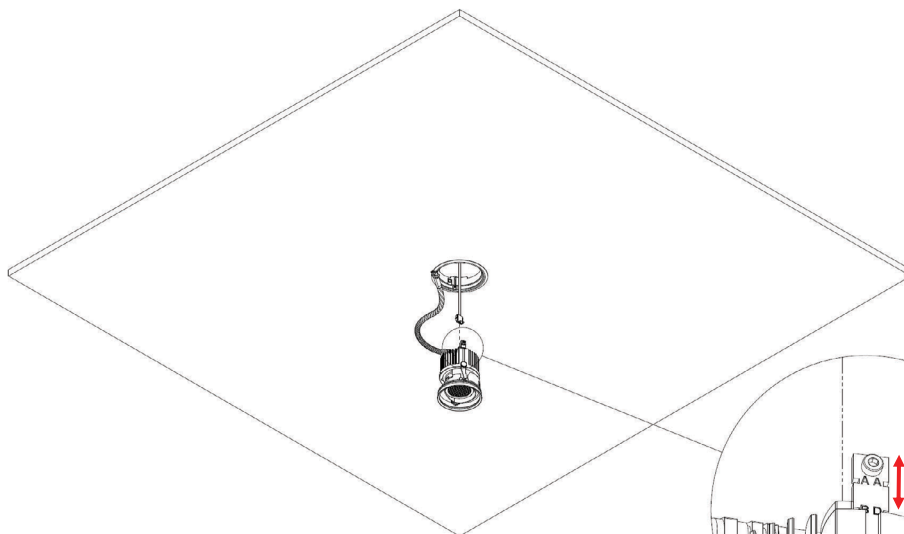

- Adjust the arm level to Beveled Down (BD) or Adjustable (AA) depending on desired trim.

DETAIL P
SCALE 1.5:1

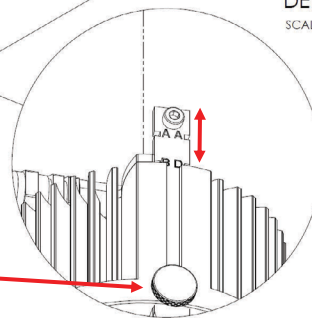

Loosen thumb screw to adjust level
Tighten to secure level

MODULE INSTALLATION

- Press the Module into the collar until you hear an audible *click*, signaling that the module is secured.

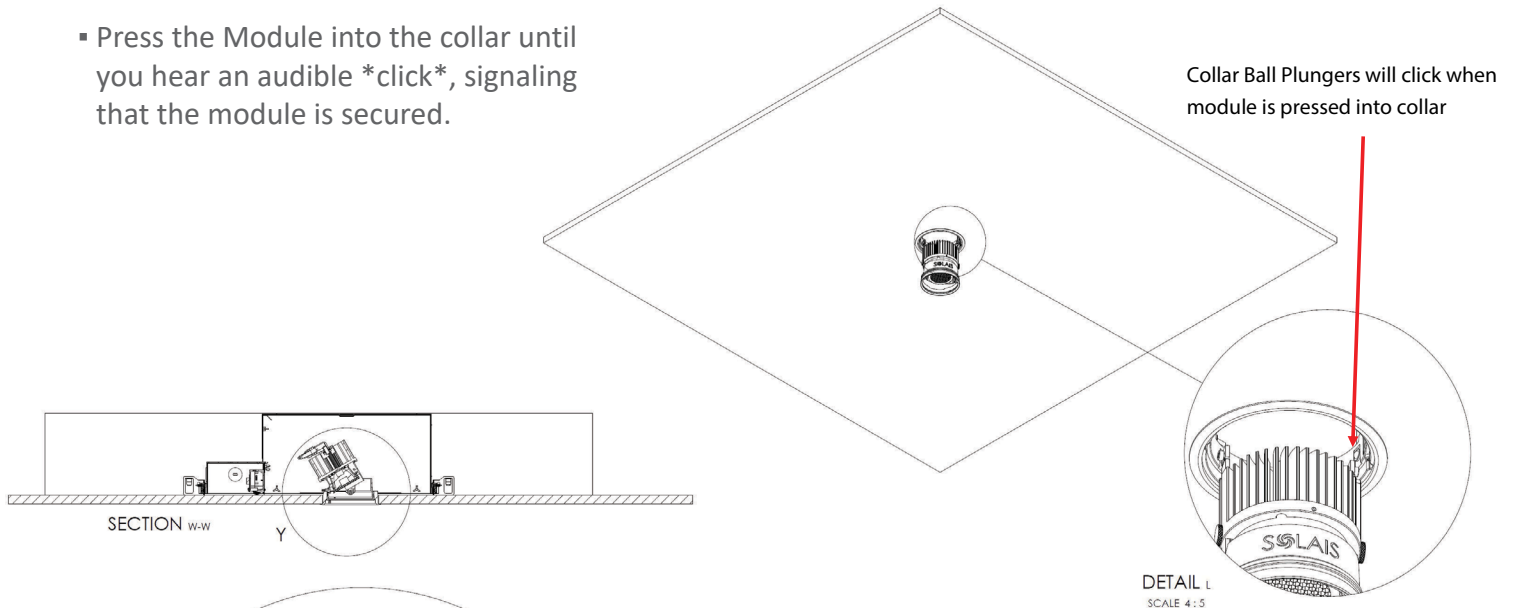

- Adjust the angle of the arm by inserting a finger into the collar aperture from below the ceiling and pushing the arm to the desired tilt angle.

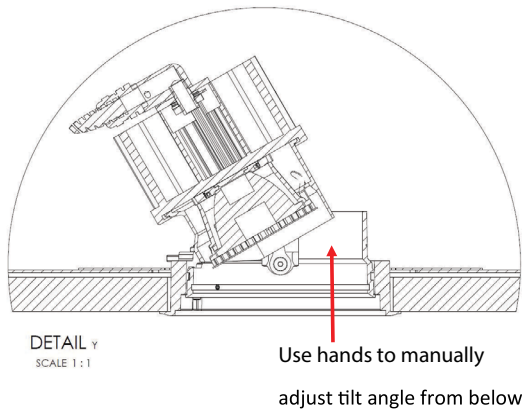

- Rotate the arm inside the collar to the desired orientation.
- Lock rotation by fastening the Hex M3 Set Screw in the Arm Ring.

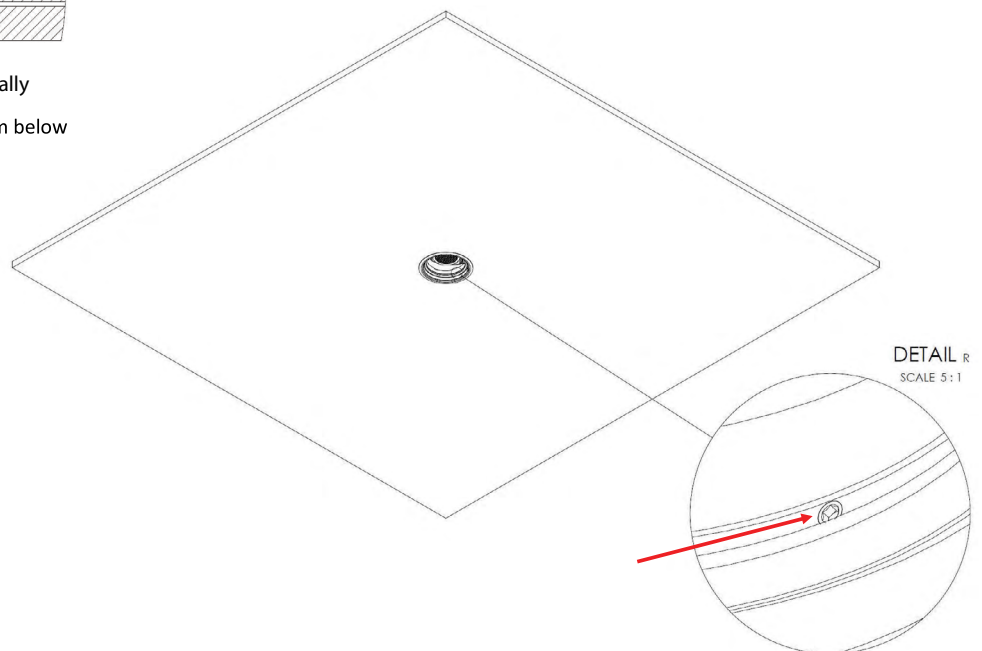

TRIM INSTALLATION

- Press the trim into the collar until you hear an audible *click*, signaling that the trim is secured.

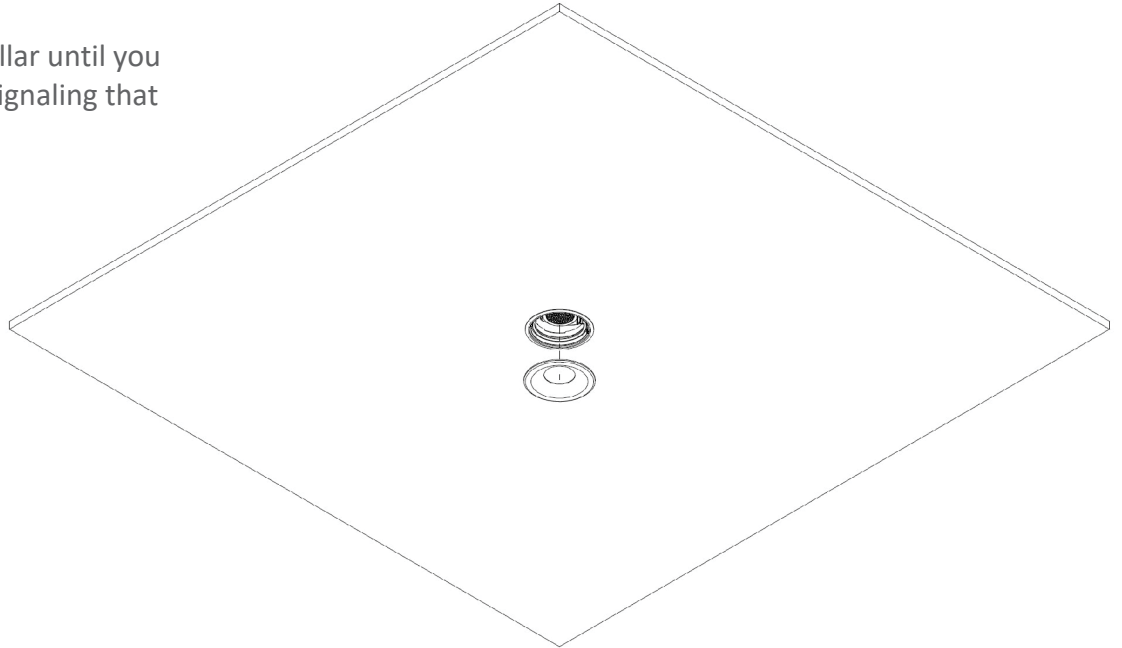

- Once secured, the installation is complete.

